

- Cave -

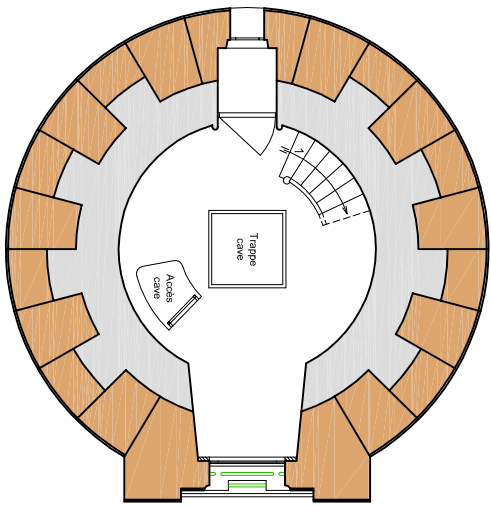

- Vestibule -

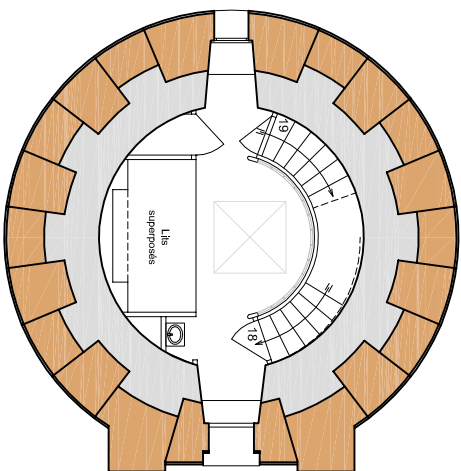

**1er étage
- Chambre -**

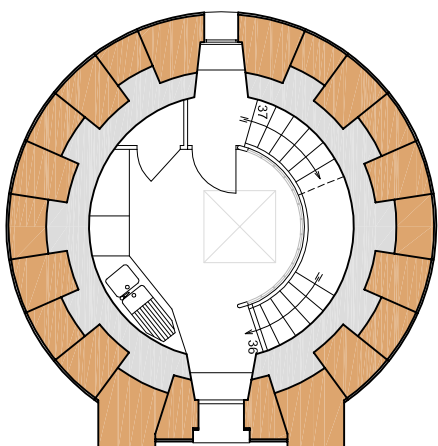

**2e étage
- Cuisine -**

**3e étage
- Chambre -**

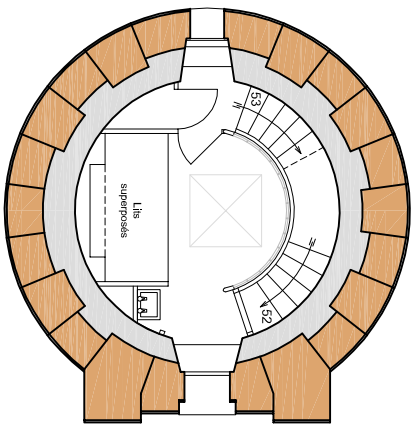

**4e étage
- Salle de veille -**

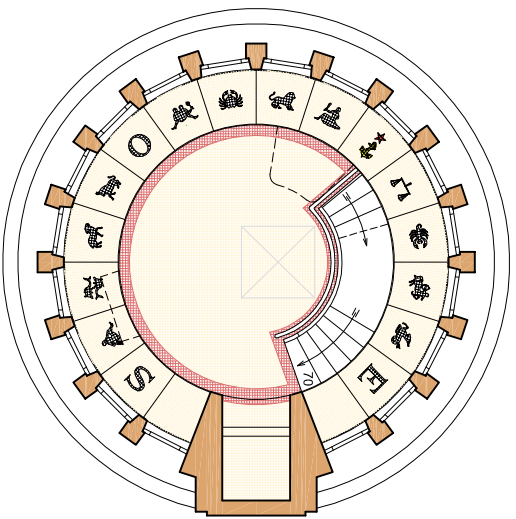

**Plan au niveau de la
- plateforme du feu -**

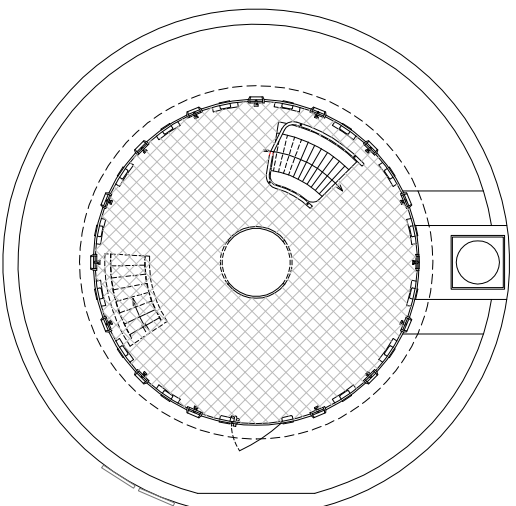

**Plan de
- la lanterne -**

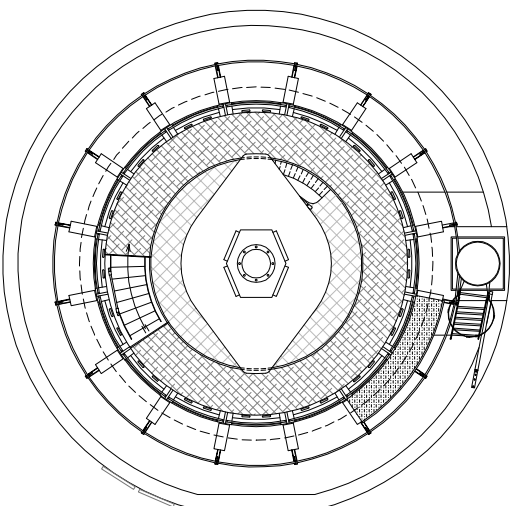

Phare du Grand Jardin

Plans horizontaux

Plan N°5

Février 2019

Établi par
S. BOULANGER

Vérifié par
N. AUGER



DIRECTION
INTERRÉGIONALE
DE LA MER
NORD-ATLANTIQUE
MANCHE-OUEST

